

© The Little Drawing Company provide a CAD drafting and submission service to clients requiring Local Authority permission for domestic building projects. All drawings produced by The Little Drawing Company are for the purposes of gaining Planning Permission or Building Regulation approval only. The Little Drawing Company is not responsible for any building work that is carried out on site. Drawings should not be used to scale from and all dimensions are to be checked on site by the contractor prior to any work being carried out.

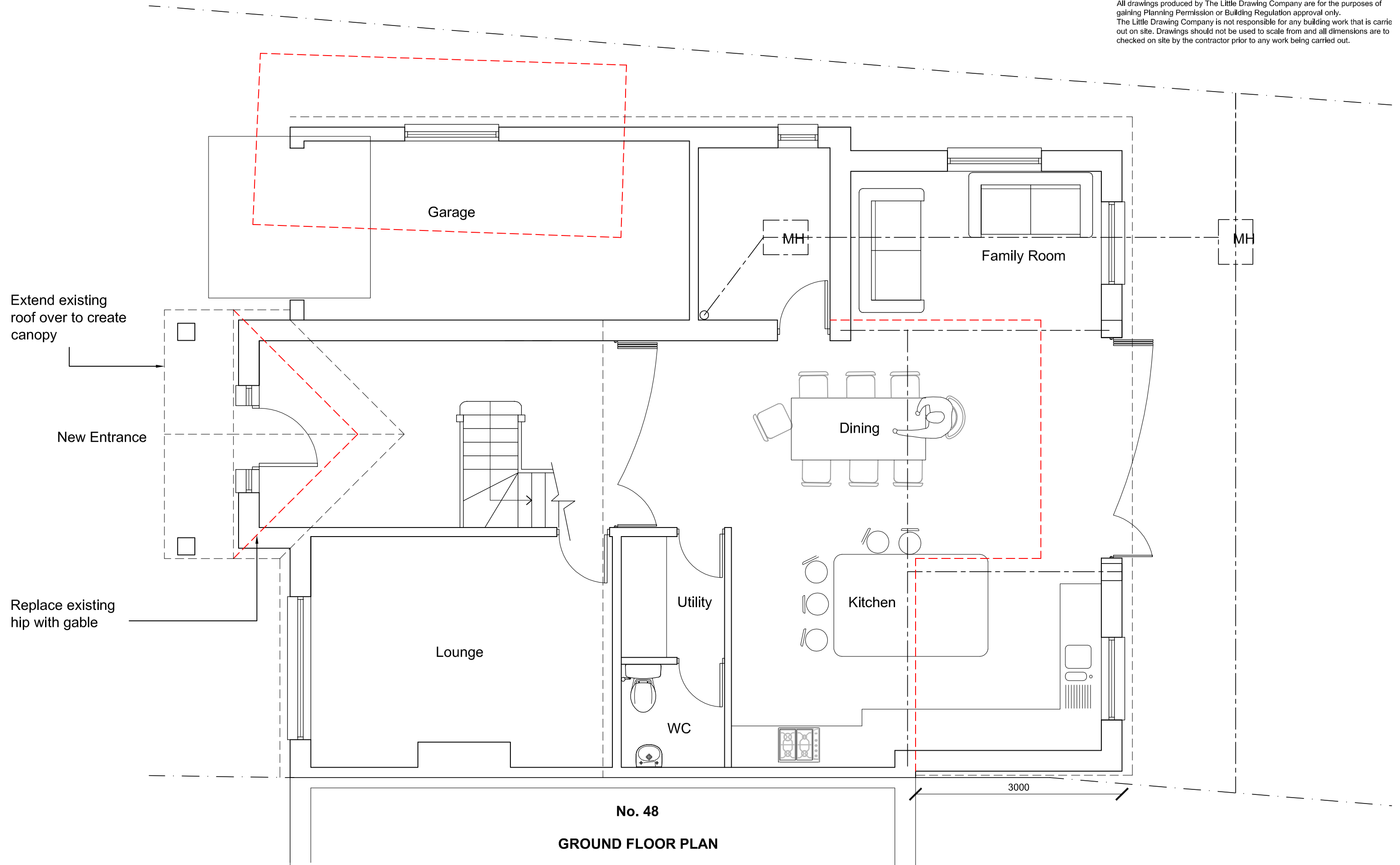

**JOB DETAIL**

**DWG. DETAIL**

PROJECT 47 Roseleigh Road,  
Sittingbourne,  
Kent

DWG. TITLE Proposed Ground Floor

SCALE 1:50

DATE MAY 2021

DWG. NO. RR/PL/06

**THE LITTLE DRAWING COMPANY**  
TIDC ARCH GMAIL.COM