

NOTES  
 This drawing must not be reissued, loaned or copied without the written consent of Richard Vest Architectural Design Ltd.  
 All errors, omissions, discrepancies should be reported to the originator immediately.  
 All dimensions to be checked before site fabrication by the contractor, his sub-contractor or supplier.  
 Do not scale plans - use figure or grid dimensions where given.  
 Any deviation from the drawing to be reported to the originator immediately.

Drawing issue status:  
 PRELIMINARY  CLIENT APPROVAL  PLANNING  AS-BUILT   
 BUILDING REGS  TENDER  CONSTRUCTION

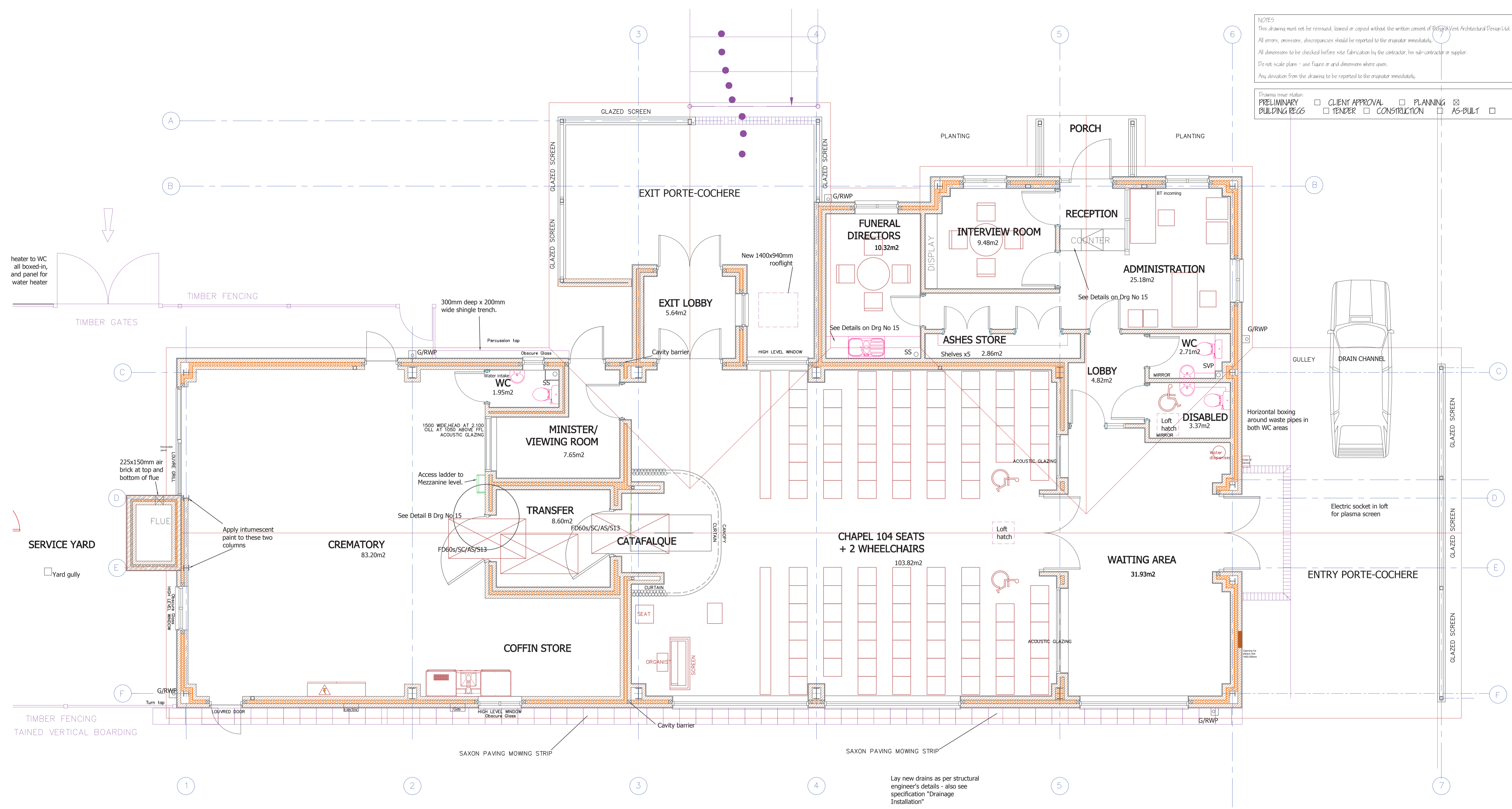

PROPOSED FLOOR PLAN

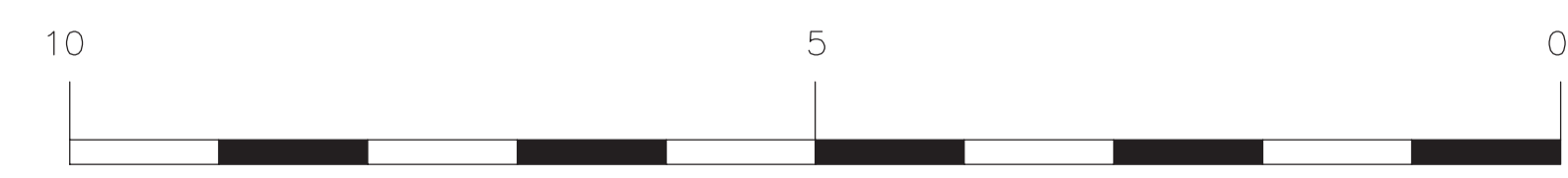
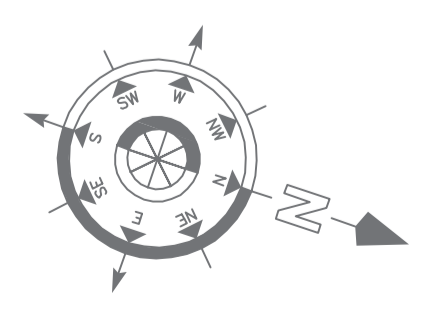

EXTERNAL AREA OF CREMATORIUM INCL EXIT & ENTRY PORTE COCHERE & PORCH	= 439 SQM
EXTERNAL AREA OF TOILET BLOCK	= 21 SQM
TOTAL EXTERNAL AREA	= 460 SQM

Lay new drains as per structural engineer's details - also see specification "Drainage Installation"

P3	18/06/20	Recalculation of total floor area
P2	24/02/20	Stonework omitted
P1	08/11/19	Planning Stage issue

REV	DATE	DESCRIPTION
-----	------	-------------

**RICHARD VEST ARCHITECTURAL DESIGN LTD**  
 Richard Vest BSc MRICS  
 Chartered Building Surveyor  
 25 Hartree Way, Kesgrave, Ipswich, IP5 2DY  
 Tel: 01473 805675; Mobile: 07949 824340,  
 E-mail: richard@richardvest.co.uk  
 Website: www.richardvest.co.uk

PROJECT	CLIENT		
NORTH KENT CREMATORIUM	MEMORIA LTD		
SUBJECT	DRG SIZE	DATE	SCALE
FLOOR PLAN	A1	08/11/19	1:50
PROJECT NR	DRAWING NR	REV	DRAWN CHECKED
19-35	02	P3	GRV