

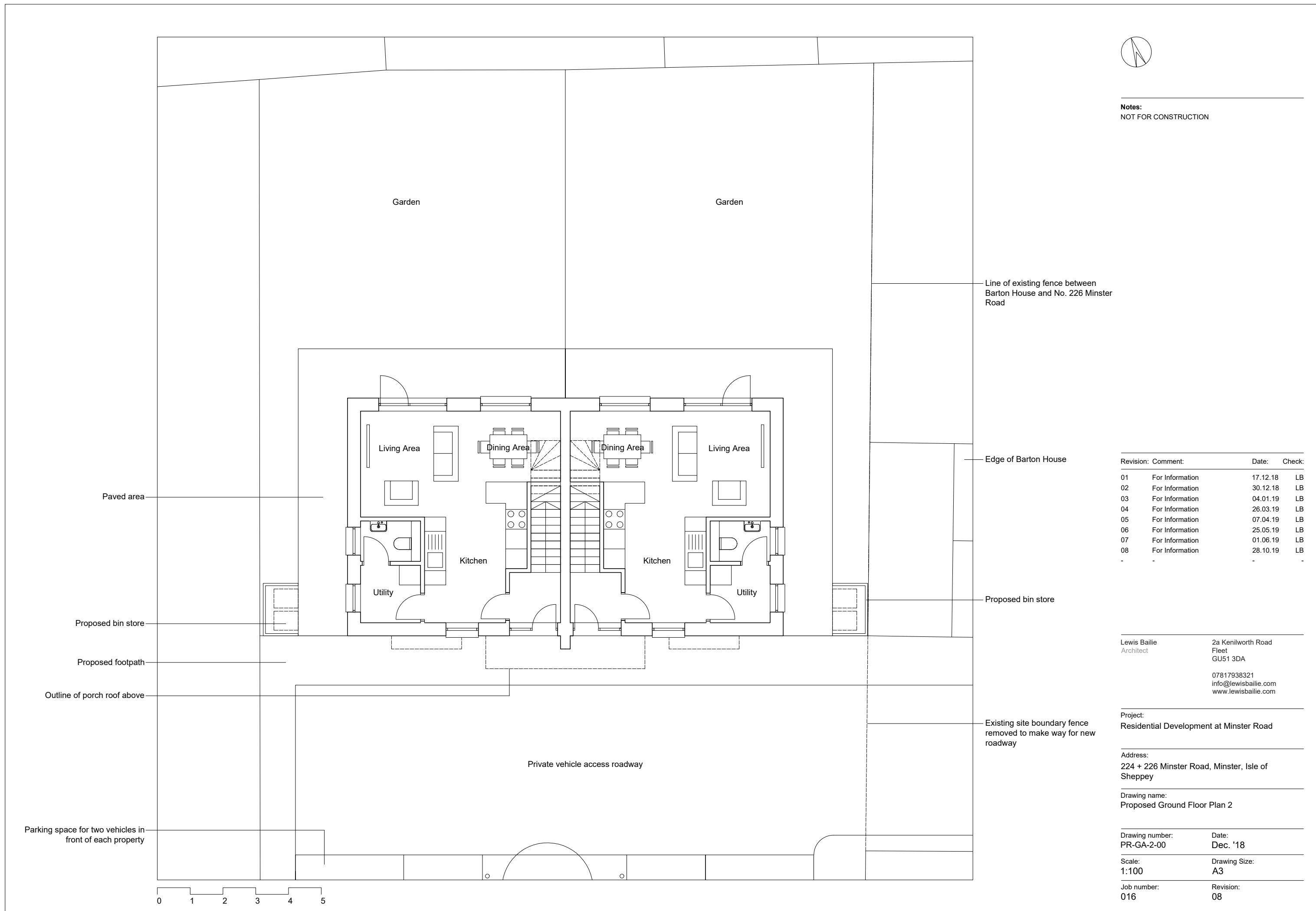

**Notes:**  
NOT FOR CONSTRUCTION



Line of existing fence between Barton House and No. 226 Minster Road

Edge of Barton House

Proposed bin store

Existing site boundary fence removed to make way for new roadway

Revision:	Comment:	Date:	Check:
01	For Information	17.12.18	LB
02	For Information	30.12.18	LB
03	For Information	04.01.19	LB
04	For Information	26.03.19	LB
05	For Information	07.04.19	LB
06	For Information	25.05.19	LB
07	For Information	01.06.19	LB
08	For Information	28.10.19	LB
-	-	-	-

Lewis Bailie  
Architect

2a Kenilworth Road  
Fleet  
GU51 3DA

07817938321  
info@lewisbailie.com  
www.lewisbailie.com

Project:  
Residential Development at Minster Road

Address:  
224 + 226 Minster Road, Minster, Isle of Sheppey

Drawing name:  
Proposed Ground Floor Plan 2

Drawing number:  
PR-GA-2-00

Date:  
Dec. '18

Scale:  
1:100

Drawing Size:  
A3

Job number:  
016

Revision:  
08



Paved area

Proposed bin store

Proposed footpath

Outline of porch roof above

Parking space for two vehicles in front of each property

Garden

Garden

Living Area

Dining Area

Dining Area

Living Area

Kitchen

Kitchen

Utility

Utility

Private vehicle access roadway